

# **Consideration of the Formation of a Library District**

## **Hailey Public Library and Bellevue Public Library**

The Hailey Public Library and Bellevue Public Library are exploring the formation of a library district to serve their communities in a more sustainable, accessible, and equitable manner. Establishing a district library would allow both libraries to consolidate resources and deliver stronger, more consistent services to residents of Hailey, Bellevue, and the surrounding rural areas of Blaine County.

A district structure provides a stable, dedicated funding source through a voter-approved property tax levy, reducing reliance on city general funds and annual budget fluctuations. This model supports long-term financial predictability, strategic planning, and operational stability.

## **Proposed District Boundaries**

The approximate boundaries of the proposed library district begin at Greenhorn and East Fork Road and extend south to the county line, excluding the area served by the Little Wood River Library District in the southeastern portion of the county, including Carey and Picabo.

## **What Is a Library District?**

A library district is an independent taxing district and separate political subdivision that provides library resources and services within a defined geographic area. It is governed by a five-member elected board, with trustees serving staggered six-year terms.

The elected board is responsible for oversight of district operations, including:

- Budget development and approval
- Adoption of bylaws and policies
- Hiring and governance of the library district director

This structure provides direct voter oversight and accountability.

## **Petition and Public Hearing Process**

To qualify for ballot consideration, signatures from 20% of the registered voters in the proposed district were collected and certified by the County Elections Department on January 27.

The required notice of public hearing before the Blaine County Board of Commissioners was published on February 11 and 18. The public hearing is scheduled for February 24.

Following the public hearing, the Board of County Commissioners may approve placement of the measure on the ballot.

On May 19, 2026, registered voters residing within the defined district boundaries will vote on the formation of the proposed library district. A simple majority is needed for passage.

# Rationale for a Library District

A district model would allow for:

- Greater flexibility to expand services for youth, seniors, and working families
- Broader access to physical and digital collections
- Improved staffing and programming capacity
- Consistent, long-term funding dedicated specifically to library services
- Enhanced strategic planning to manage growth and community needs

A district aims to establish a predictable funding source while leveraging economies of scale to improve service delivery and operational efficiency. Funds generated through the district levy would support:

- Staffing and administration
- Collection development, including digital resources and subscriptions
- Programs and outreach services
- Technology infrastructure
- Facilities maintenance and capital improvements

The district structure enables local voters to determine library funding and governance while ensuring equitable access to high-quality library services for residents of Hailey, Bellevue, and the surrounding rural county.

# Beyond

THE BOOKS  
2025



## FULL HOUSE IN A HOUSE OF BOOKS

- ✓ 8,281 TEEN VISITS
- ✓ 6,450 CHILDREN ATTENDED EVENTS ONSITE
- ✓ 35,688 WIFI SESSIONS
- ✓ 15,523 COMPUTER USES
- ✓ 879 MEETING ROOM RESERVATIONS
- ✓ 948 NEW PATRONS ADDED IN 2025
- ✓ 111,532 PATRON VISITS FOR THE YEAR

## Hailey Public Library cardholders comprised of:

**3,692 Hailey residents**

**1,565 Bellevue residents**

**905 rural county residents**

## THE HEART OF TOWN

- ✓ 234 ADULT PROGRAMMING EVENTS WITH OVER 2000+ ATTENDEES
- ✓ 25,000+ PRINT JOBS COMPLETED
- ✓ 1,186 LUNCHESES SERVED AS PART OF THE HUNGER COALITION'S SUMMER PROGRAM
- ✓ 3,300 POUNDS OF SAND FOR THE KIDS' MUD KITCHEN
- ✓ 2000+ HISTORICAL DIGITAL PHOTOS IN THE MARTYN MALLORY COLLECTION

## LEARN HERE

- ✓ ENGLISH LANGUAGE CLASSES
- ✓ IDAHO COURT ASSISTANCE & SELF HELP CENTER
- ✓ BEST SELLING AUTHOR TALKS
- ✓ OPEN TEXTBOOK ONLINE LIBRARY
- ✓ WORLD BOOK FOR STUDENTS AND ADULTS
- ✓ SMALL BUSINESS RESOURCES

## LIBRARY OF THINGS

SEWING MACHINES  
GAMES AND PUZZLES  
UKULELES  
HOT SPOTS  
STEAM KITS  
SEED LIBRARY  
YOTO PLAYERS

## **MARK YOUR CALENDARS**

YEAR ROUND - 4 WEEKLY STORY TIMES  
YEAR ROUND - MAKERS SPACE AND CRAFTS  
YEAR ROUND - ADULT AND TEEN BOOK CLUB  
FEB-VALLEY WIDE WINTER READ  
FEB-BLIND DATE WITH A BOOK  
JUNE - AUG- SUMMER READING  
AUG-SUMMER READING CELEBRATION  
OCT - ANNUAL BOOK SALE  
DEC-LETTERS TO SANTA & MRS. CLAUS VISIT



## **CHECK US OUT**

- ✔ 51,161 YOUTH MATERIALS CIRCULATED
- ✔ 34,671 ADULT MATERIALS CIRCULATED
- ✔ 4,272 REFERENCE QUESTIONS ANSWERED
- ✔ 7,614 DVDS CIRCULATED
- ✔ 27,741 DIGITAL MATERIALS CIRCULATED
- ✔ 547 INTER-LIBRARY LOAN REQUESTS

## **PUBLIC SERVICE & HEALTH**

- ✔ TELEHEATH APPOINTMENTS
- ✔ HEALTH CONSULTATIONS WITH ST. LUKES
- ✔ PROCTOR EXAMS - OVER 100+ ANNUALLY
- ✔ STUDY PODS AND MEETING SPACES
- ✔ READERS' ADVISORY & REFERENCE ASSISTANCE

## **SAVE MONEY, WE'VE GOT YOU COVERED**

- ✔ WALL STREET JOURNAL - FREE ACCESS
- ✔ THE NEW YORK TIMES - COOKING & GAMES TOO
- ✔ IDAHO DIGITAL SKILLS - RESUMES, S.A.T PREP & MORE
- ✔ FREE AUDIOBOOKS, MAGAZINES AND EBOOKS
- ✔ MANGO LANGUAGE - INCLUDING ASL AND LIL PIM FOR YOUTH



**UNITING PEOPLE, SPARKING IDEAS: TOWARD A BRILLIANT 2026**

## Exhibit A: Legal Description

A parcel of Land located within Blaine County Idaho being more particularly described as follows:

All those portions of the following Townships, Sections, Ranges, and Subdivisions that fall within the boundaries of Blaine County Idaho as follows:

Township 4 North Range 18 East Sections 25, 35,36 and the South East  $\frac{1}{4}$  of Section 34;

Township 4 North Ranges 19 East through Range 22 East within Blaine County;

Township 3 North Range 15 East Sections 9 through 16 and Sections 23 through 25 Within Blaine County;

Township 3 North Ranges 16 and Range 17 East, Sections 7 through 36 Within Blaine County;

Township 3 North Range 18 East:

Sections 1 through 4 and Sections 9 through 36;

South  $\frac{1}{2}$  of Section 7;

Gimlet West Subdivision, recorded under Instrument number 301511 as described in the records of Blaine County, Idaho, or subsequent replats thereof, which is located within the NE  $\frac{1}{4}$  of Section 7;

Section 8 excepting the North West  $\frac{1}{4}$ ;

Township 3 North Ranges 19 East through Range 23 East within Blaine County;

Township 2 North Ranges 16 East through Range 24 East within Blaine County;

Township 1 North Ranges 16 East through Range 21 East, and Ranges 23 East through Range 24 East within Blaine County;

Township 1 North Range 22 East EXCEPT the following portions of Section 32 & 33:

Within Section 32 the South East  $\frac{1}{4}$ , the South East  $\frac{1}{4}$  of the South West  $\frac{1}{4}$ , and the South East  $\frac{1}{4}$  of the North East  $\frac{1}{4}$ ;

Within Section 33 the South  $\frac{1}{2}$ , and the South East  $\frac{1}{4}$  of the North East  $\frac{1}{4}$ ;

Township 1 South Ranges 16 East through Range 19 East within Blaine County;

Township 1 South Range 20 East Sections 5 through 7;

Township 1 South Range 20 East portions of Sections 8, 18, and 19 as follows:

Government Lots 3 and 4 of Section 8;

The West  $\frac{1}{2}$  of Section 18;

The North  $\frac{1}{2}$  of the North West  $\frac{1}{4}$  of Section 19;

Township 2 South Ranges 17 East through Range 19 East within Blaine County;

Said parcel containing approximately \_\_\_\_\_ Square Miles, more or less.

See Exhibit Map attached hereto and made part of this description.

# EXHIBIT A

5 Miles  
ISTC, IDWR

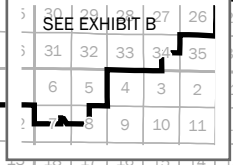
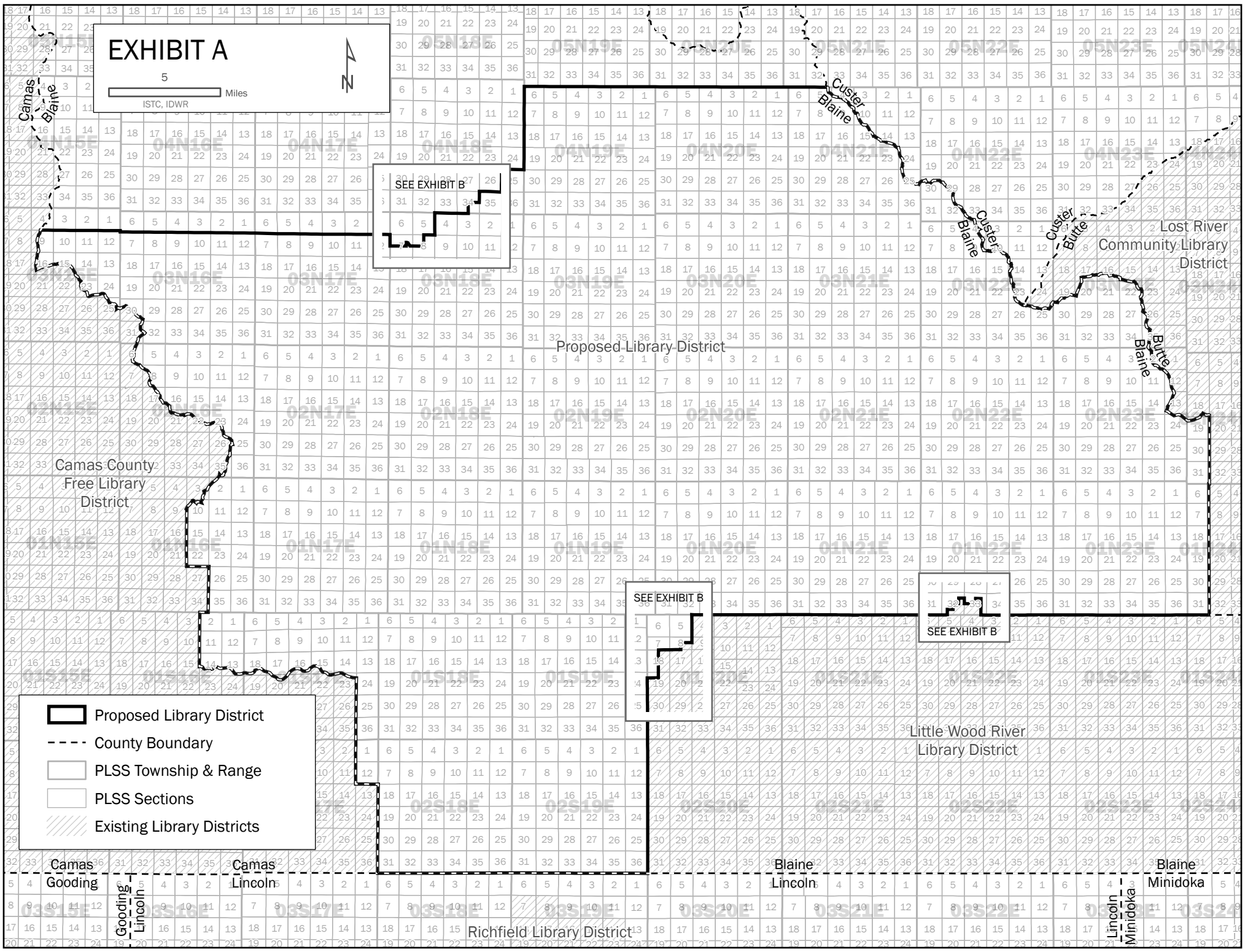

- Proposed Library District
- County Boundary
- PLSS Township & Range
- PLSS Sections
- Existing Library Districts

Camas Gooding Lincoln Lincoln Blaine Blaine  
Lincoln Minidoka

Richfield Library District

Little Wood River Library District

Community Library District  
Lost River

# EXHIBIT B

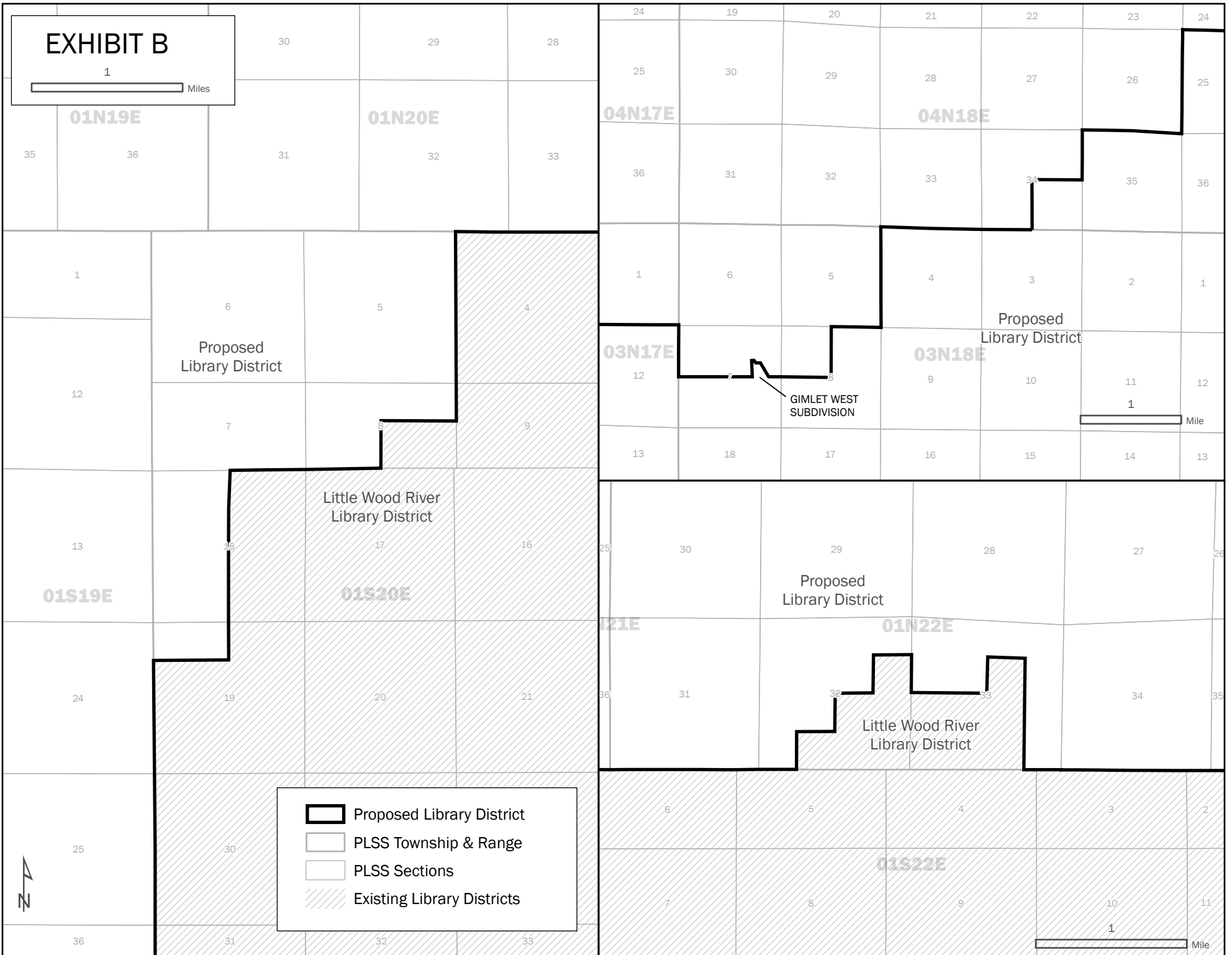
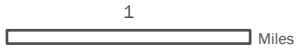

- Proposed Library District
- PLSS Township & Range
- PLSS Sections
- Existing Library Districts